

PRODUCT INSTRUCTION SHEET

Titansuhe

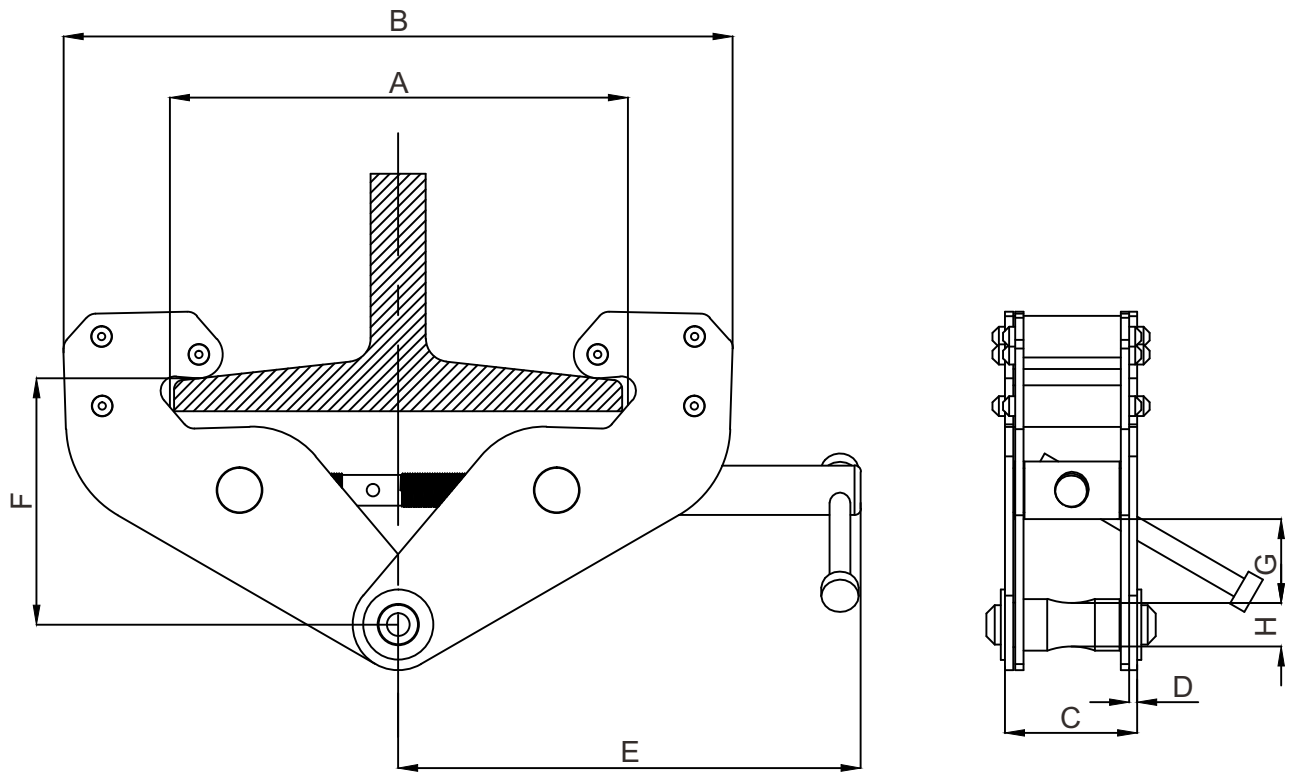

Beam Clamp



Capacity (t)	Applicable beam width (mm)	A (mm)	B (mm)	C (mm)	D (mm)	E (mm)	F (mm)	G (mm)	H (mm)	N.W. (kg)
1	75-230	230	337	64	4	220	114	36.5	21	3.6
2	75-230	230	437	64	6	220	114	36.5	21	4.5
3	80-320	320	467	100	8	243	174	56	26	9.1
5	80-320	320	486	112	10	240	170	76	32	11.2
10	90-320	320	500	120	12	270	226	87.5	39	17.2

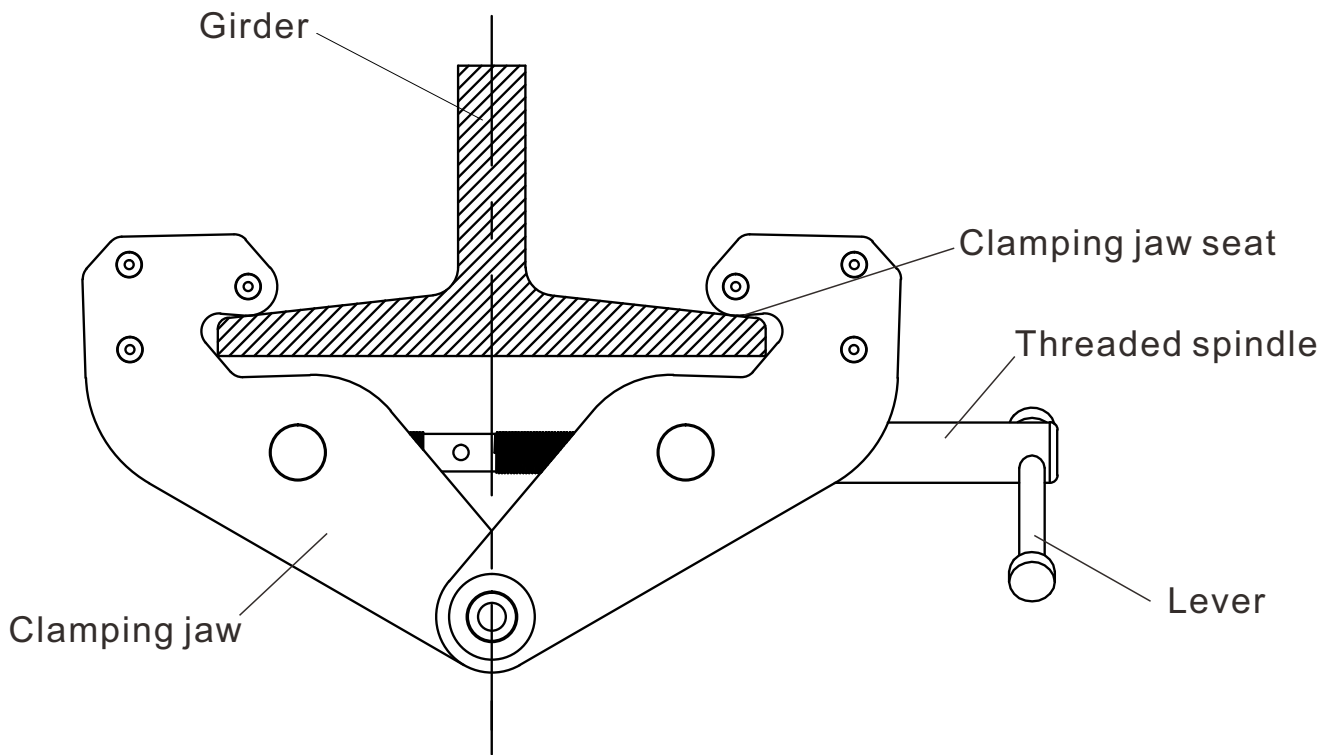

INSTALLATION INSTRUCTIONS :

1. Open the clamping jaws by rotating the lever counter-clockwise.
2. Position the clamp on the girder.
3. Close the clamping jaws by rotating the lever clockwise until hand tight.
4. Check that the clamping jaw seat has engaged the girder fully.
5. Ensure the hoist or sling being attached to the girder clamp is located directly under the centre-line of both the girder and the clamp.

WARNING:

- USE ONLY on girder widths that are within the adjustable limits of the clamp.
- DO NOT exceed the W.L.L. of the clamp.
- DO NOT use clamps which are damaged or deformed.
- Do inspect the clamp after every use.
- DO NOT attempt to repair a damaged clamp - it must be repaired by an authorised repair agent.
- DO NOT stand under load or installed clamp.

W.L.L.	Beam With (mm)
1t	75-230
2t	75-230
3t	80-320
5t	90-320
10t	90-320

USE THIS PRODUCT BY QUALIFIED PERSONS.